

Cable Jointing Material Kit for Housing Complex “F-Touch Cover Mini”

1. INTRODUCTION

Recently, as home electric appliances become more diversified accompanied by increasing demand, a rapid growth is seen in electrical work to upgrade the power receiving capacity of housings. Many owners including Urban Renaissance Agency are systematically implementing a plan of trunk cable upgrading (i.e., 40 A per household) to increase the power receiving capacity of housings. In the case of housing complexes, since branch cables are mainly used for power distribution from the common trunk cable to every household, a wide variety of working methods are employed to deal with the actual site conditions. Moreover, unlike new installation works, the capacity upgrading work faces demanding site conditions such as limited existing spaces as well as brief working hours to shorten interruption of electric service.

In order to respond to such market trends, we have been working on the application of our proprietary cable jointing technologies to develop new cable jointing materials exclusively for housing complex, and have succeeded in launching the sale of various products including “F-Touch Cover” for bundle jointing of triplex cables. We have recently expanded the applicability of the existing products to add “F-Touch Cover Mini” shown in Figure 1 to our product lineup. The new product is the most compact sized branching joint in the industry with two branch arms on either side. This F-Touch Cover Mini allows for two-arm branching work comfortably and assuredly inside a horizontal cable duct of approx. 80 mm x 70 mm in inner dimension.



Figure 1 Appearance of F-Touch Cover Mini.

2. F-TOUCH COVER MINI

2.1 Features

Whereas the conventional F-Touch Cover for bundle jointing of triplex cables provides two branches to the same direction with respect to a vertical trunk cable as shown in Figure 2, F-Touch Cover Mini developed here is a cable jointing kit exclusively for two-arm, either-side branching of a horizontal trunk cable in a cable duct. See Figure 3.

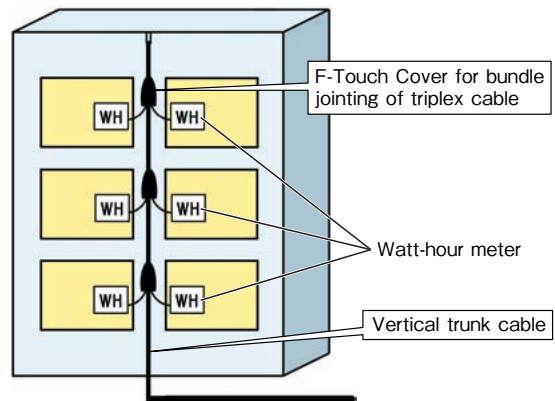

Figure 2 Vertical trunk cable at housing complex.

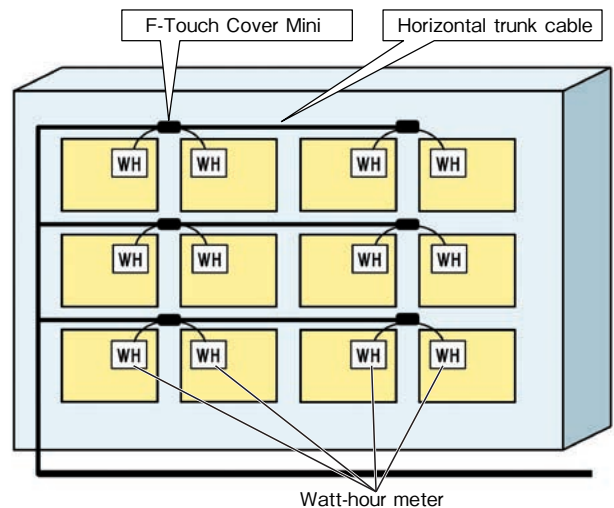
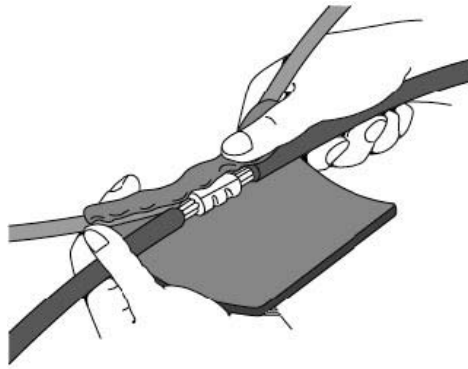
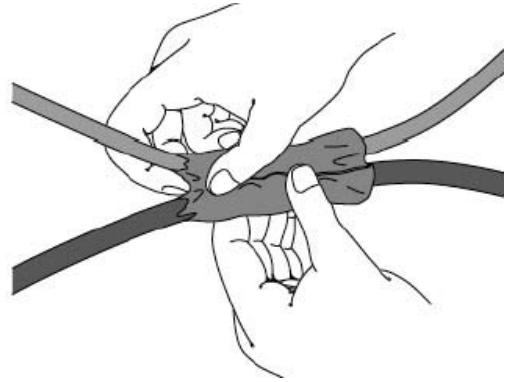

Figure 3 Horizontal trunk cable at housing complex.



(a) Putty sheet is wrapped.



(b) Putty sheet is pressed into to stick.

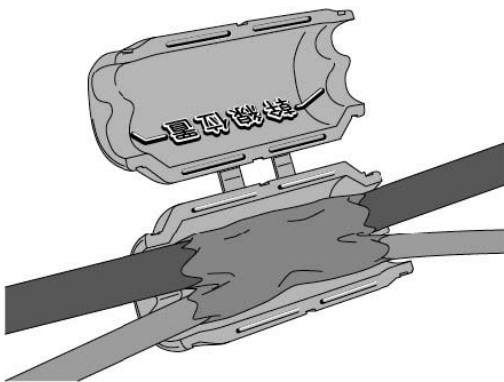

(c) Cover is attached.

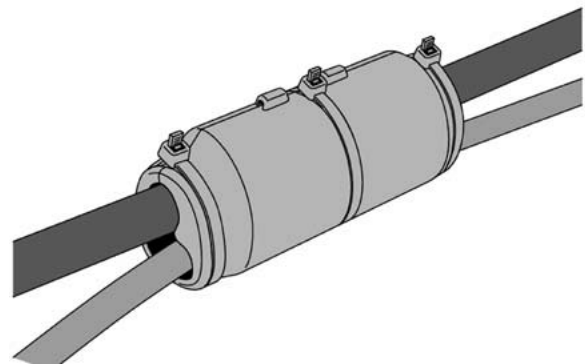

(d) Finished product.

Figure 4 Assembly of F-Touch Cover Mini.

This jointing kit has been designed, limiting its intended applications to indoor environments only and taking advantage of thin-wall molding technology for its plastic cover, to provide a combination of cable sizes necessary for trunk cable repair work, thereby realizing the most compact cable joint in the industry.

2.2 Assembly Performance

The method for assembling this product is very straightforward and reliable. Just wrap the insulating putty sheet prepared exclusively onto the jointed connector, and install the attached cover. The putty sheet can easily be wrapped by anyone, and needs no curing time to wait unlike resin hardening-type jointing kit. Also, high reliability is assured since a robust cover is used to protect the putty-treated portion. See Figures 4 (a) through 4 (d). As described, the assembly work is simple and least time-consuming.

3. CONCLUSION

F-Touch Cover Mini has been developed targeted at repair work of housing main cables after the model of Urban Renaissance Agency and the like. But it is also applicable to other repair works such as those in housing complexes owned by prefectural and municipal agencies or by companies, and thus it is expected to see market expansion in the future. We intend to make efforts to develop Only-One Products in response to customers' needs, making contributions to society by offering good cable jointing materials.

For more information, please contact:

Customer Center, Engineering Dept., Furukawa Electric Industrial Cable

TEL: +81-463-21-8289 FAX: +81-463-24-8292