

REF.NO. OPC 21006D

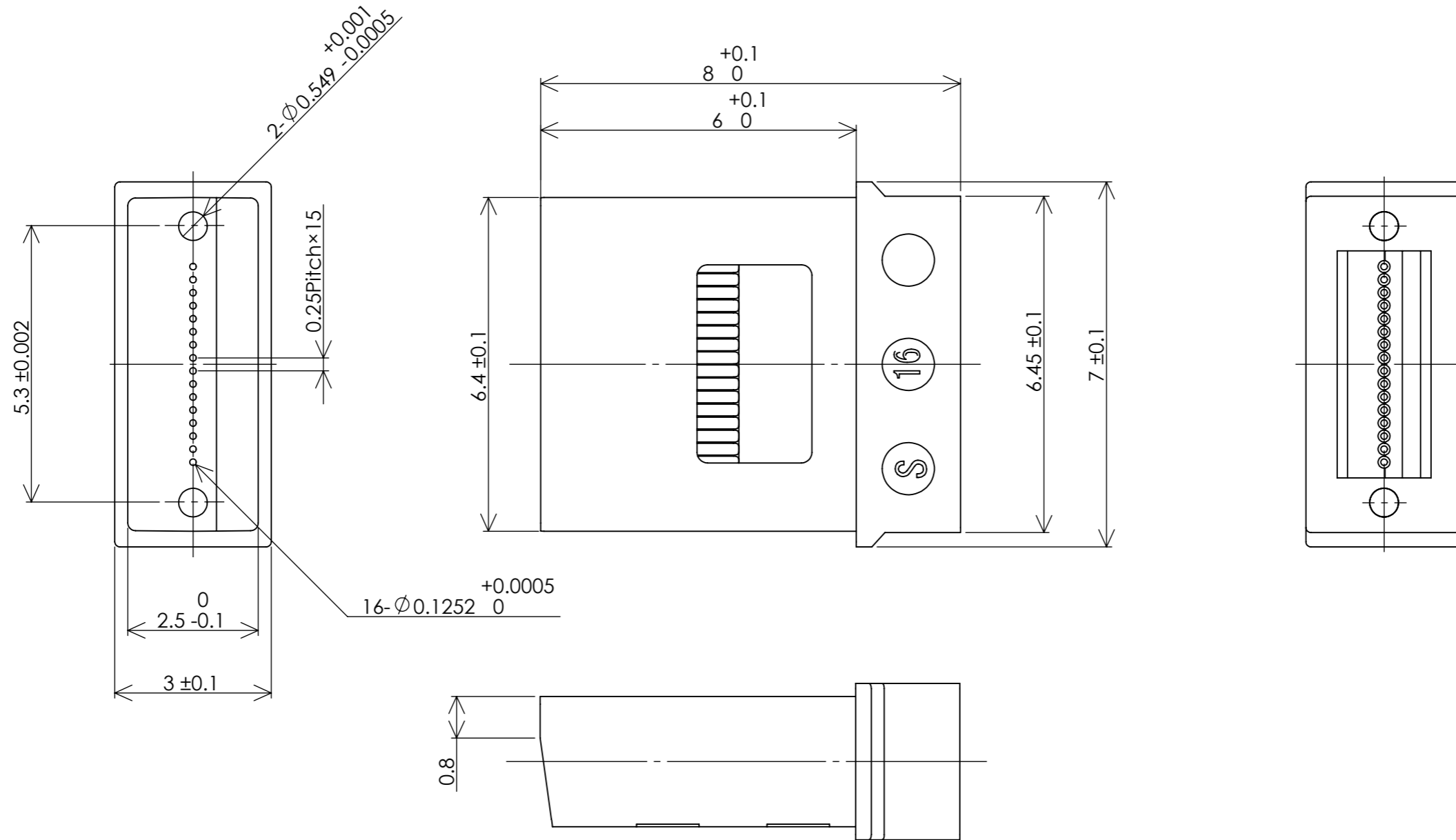

Note:

For proper performance of MT ferrule, appropriate assembly with well managed fiber is required.
Guide pins should have a diameter of 0.5485 ± 0.0001 mm for proper performance.

Unit:mm
Not to scale

| | | | |
|-----|----------|----------|------|
| 1 | Ferrule | Plastic | 1 |
| No. | Descript | Material | Q'ty |

TITLE

MT16 SM Plus-B Pre-Angled Ferrule